



BSI Standards Publication

<https://www.china-gauges.com/>

# Testing of welded joints of thermoplastics semi-finished products

---

Part 7: Tensile test with waisted test specimens

## National foreword

This British Standard is the UK implementation of EN 12814-7:2024 and it supersedes BS EN 12814-7:2002, which is withdrawn.

The UK participation in its preparation was entrusted to Technical Committee WEE/3, Welding of thermoplastic moulded components.

A list of organizations represented on this committee can be obtained on request to its committee manager.

### Contractual and legal considerations

This publication has been prepared in good faith, however no representation, warranty, assurance or undertaking (express or implied) is or will be made, and no responsibility or liability is or will be accepted by BSI in relation to the adequacy, accuracy, completeness or reasonableness of this publication. All and any such responsibility and liability is expressly disclaimed to the full extent permitted by the law.

This publication is provided as is, and is to be used at the recipient's own risk.

The recipient is advised to consider seeking professional guidance with respect to its use of this publication.

This publication is not intended to constitute a contract. Users are responsible for its correct application.

© The British Standards Institution 2024  
Published by BSI Standards Limited 2024

ISBN 978 0 539 22624 9

ICS 25.160.40

### Compliance with a British Standard cannot confer immunity from legal obligations.

This British Standard was published under the authority of the Standards Policy and Strategy Committee on 31 March 2024.

### Amendments/corrigenda issued since publication

Date	Text affected
------	---------------

---

EUROPEAN STANDARD

EN 12814-7

NORME EUROPÉENNE

EUROPÄISCHE NORM

March 2024

ICS 25.160.40

Supersedes EN 12814-7:2002

English Version

## Testing of welded joints of thermoplastics semi-finished products - Part 7: Tensile test with waisted test specimens

Essais des assemblages soudés sur produits semi-finis en thermoplastiques - Partie 7 : Essai de traction avec éprouvettes entaillées

Prüfen von Schweißverbindungen an Halbzeugen aus thermoplastischen Kunststoffen - Teil 7: Zugversuch an Probekörpern mit Rundkerbe

This European Standard was approved by CEN on 15 January 2024.

CEN members are bound to comply with the CEN/CENELEC Internal Regulations which stipulate the conditions for giving this European Standard the status of a national standard without any alteration. Up-to-date lists and bibliographical references concerning such national standards may be obtained on application to the CEN-CENELEC Management Centre or to any CEN member.

This European Standard exists in three official versions (English, French, German). A version in any other language made by translation under the responsibility of a CEN member into its own language and notified to the CEN-CENELEC Management Centre has the same status as the official versions.

CEN members are the national standards bodies of Austria, Belgium, Bulgaria, Croatia, Cyprus, Czech Republic, Denmark, Estonia, Finland, France, Germany, Greece, Hungary, Iceland, Ireland, Italy, Latvia, Lithuania, Luxembourg, Malta, Netherlands, Norway, Poland, Portugal, Republic of North Macedonia, Romania, Serbia, Slovakia, Slovenia, Spain, Sweden, Switzerland, Türkiye and United Kingdom.



EUROPEAN COMMITTEE FOR STANDARDIZATION  
COMITÉ EUROPÉEN DE NORMALISATION  
EUROPÄISCHES KOMITEE FÜR NORMUNG

CEN-CENELEC Management Centre: Rue de la Science 23, B-1040 Brussels

## Contents

	Page
European foreword.....	3
<b>1 Scope .....</b>	<b>4</b>
<b>2 Normative references.....</b>	<b>4</b>
<b>3 Terms and definitions.....</b>	<b>4</b>
<b>4 Symbols and designations .....</b>	<b>5</b>
<b>5 Principle of the test.....</b>	<b>5</b>
<b>6 Sampling procedures.....</b>	<b>5</b>
<b>7 Dimensions of test specimens.....</b>	<b>5</b>
<b>8 Cutting of test specimens .....</b>	<b>6</b>
<b>9 Mechanical testing.....</b>	<b>7</b>
<b>10 Test equipment.....</b>	<b>7</b>
<b>11 Determination of the tensile energy welding factor .....</b>	<b>7</b>
<b>12 Test report .....</b>	<b>8</b>
<b>Annex A (normative) Cutting specimens of thickness &gt; 30 mm into two or more layers.....</b>	<b>9</b>
<b>Annex B (informative) Test speeds for some thermoplastic materials .....</b>	<b>10</b>

## European foreword

This document (EN 12814-7:2024) has been prepared by Technical Committee CEN/TC 249 “Plastics”, the secretariat of which is held by SIS.

This European Standard shall be given the status of a national standard, either by publication of an identical text or by endorsement, at the latest by September 2024, and conflicting national standards shall be withdrawn at the latest by September 2024.

Attention is drawn to the possibility that some of the elements of this document may be the subject of patent rights. CEN shall not be held responsible for identifying any or all such patent rights.

This document supersedes EN 12814-7:2004.

In comparison with the previous edition, the following technical modifications have been made:

- the symbols in “Figure 1 — Waisted tensile test specimen” have been added to “Table 1 — Symbols and designations”;
- modification in Clause 6 following dimensions of test specimens;
- “Table 2 — Dimensions of test specimens” has been added;
- in Table B.1, the test speed for PA-U materials has been added.

Any feedback and questions on this document should be directed to the users’ national standards body. A complete listing of these bodies can be found on the CEN website.

According to the CEN-CENELEC Internal Regulations, the national standards organisations of the following countries are bound to implement this European Standard: Austria, Belgium, Bulgaria, Croatia, Cyprus, Czech Republic, Denmark, Estonia, Finland, France, Germany, Greece, Hungary, Iceland, Ireland, Italy, Latvia, Lithuania, Luxembourg, Malta, Netherlands, Norway, Poland, Portugal, Republic of North Macedonia, Romania, Serbia, Slovakia, Slovenia, Spain, Sweden, Switzerland, Türkiye and the United Kingdom.

## 1 Scope

This document specifies the dimensions, the method of sampling, the preparation of the test specimens and the conditions for performing the tensile test with waisted test specimens in order to determine the tensile energy welding factor.

A tensile test with waisted specimens can be used in conjunction with other tests (e.g. bend, tensile, tensile creep, macro, etc.) to assess the performance of welded assemblies, made from thermoplastics materials.

The test is applicable to co-axial or co-planar heated tool butt welded assemblies made from thermoplastics materials filled or unfilled, but not reinforced. It is not applicable to tubular assemblies with a nominal outside diameter less than 90 mm.

## 2 Normative references

The following documents are referred to in the text in such a way that some or all of their content constitutes requirements of this document. For dated references, only the edition cited applies. For undated references, the latest edition of the referenced document (including any amendments) applies.

EN 13100-1, *Non-destructive testing of welded joints of thermoplastics semi-finished products — Part 1: Visual examination*

EN ISO 527-1, *Plastics — Determination of tensile properties — Part 1: General principles (ISO 527-1)*

ISO 5893, *Rubber and plastics test equipment — Tensile, flexural and compression types (constant rate of traverse) — Specification*

## 3 Terms and definitions

No terms and definitions are listed in this document.

ISO and IEC maintain terminology databases for use in standardization at the following addresses:

- ISO Online browsing platform: available at <https://www.iso.org/obp>
- IEC Electropedia: available at <https://www.electropedia.org/>

## 4 Symbols and designations

Symbols and designations are given in Table 1.

Table 1 — Symbols and designations

Symbols and abbreviations	Designations	Units
$f_e$	The tensile energy welding factor	—
$E_w$	The value of energy to break of the welded test specimen used in the calculation of $f_e$ <sup>a</sup>	Joule
$E_r$	The value of energy to break of the unwelded test specimens taken from the same test piece, used in the calculation of $f_e$ <sup>b</sup>	Joule
$a_n$	Nominal thickness of the test piece	millimetre
$D_n$	Nominal outside diameter of the tube	millimetre
$b_1$	Width of shoulder of the test specimen	millimetre
$b$	Width of narrow portion of test specimen	millimetre
$D$	Diameter of loading holes	millimetre
$\emptyset$	Diameter of waisted section notch	millimetre
$L_h$	Distance between loading holes	millimetre
$L$	Specimen length	millimetre
<sup>a</sup>	Area under the load/extension curve of the welded test specimen.	
<sup>b</sup>	Area under the load/extension curve of the unwelded test specimen.	

## 5 Principle of the test

The test specimen is extended along its major longitudinal axis at constant speed until the test specimen fractures. During this procedure the load and extension sustained by the test specimen is measured and the energy to break is calculated.

## 6 Sampling procedures

The test specimens (welded and unwelded) shall be cut perpendicular to the welded joint at least eight hours after welding.

Each test specimen shall be marked in order to identify its original position within the test piece.

No heat treatment or mechanical straightening operations shall be carried out on the test specimen.

## 7 Dimensions of test specimens

The dimensions of test specimens are given in Figure 1 and Table 2.

Dimensions in millimetres

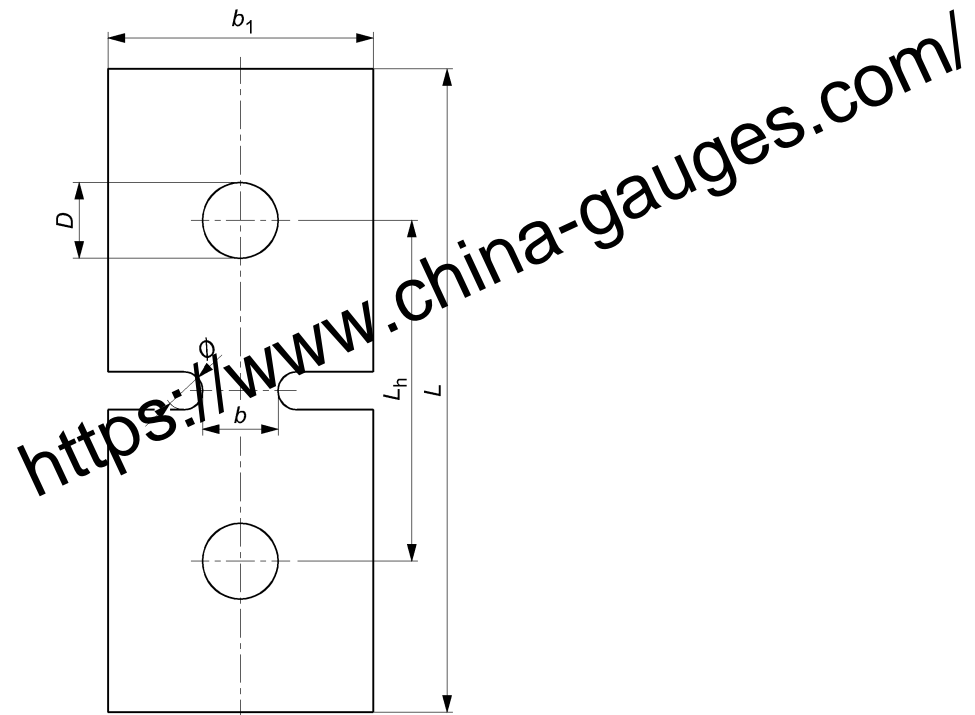

Figure 1 — Waisted tensile test specimen

Table 2 — Dimensions of test specimens

Dimensions in millimetres

$a_n$	$b$	$b_1$	$L_h$	$L$	$D$	$\phi$
$< 20$	$15 \pm 1$	$\geq 70$	$100 \pm 2$	$\geq 190$	$20 \pm 2$	$20 \pm 0,5$
$20 \leq a_n < 25$	$25 \pm 1$	$\geq 80$	$105 \pm 2$	$\geq 200$	$25 \pm 2$	$20 \pm 0,5$
$25 \leq a_n \leq 30$	$30 \pm 1$	$\geq 80$	$110 \pm 2$	$\geq 210$	$30 \pm 2$	$20 \pm 0,5$

For test piece thicknesses greater than 30 mm, the specimens shall be cut equally into two or more layers (according to Annex A). The maximum thickness of any specimen shall be 30 mm. The outer surfaces of the test piece shall not be machined other than to remove the weld beads.

## 8 Cutting of test specimens

The tensile test specimens shall be cut with parallel sides as shown in Figure 1.

During cutting, heating of the test specimen shall be minimized.

The radiused portions of the test specimen shall be smooth and shall contain no notches but the surface finish of the other remaining edges is not critical.

After cutting, a visual examination of the weld, according to EN 13100-1, shall be carried out and recorded.



## 9 Mechanical testing

Test specimens shall be conditioned at a temperature of  $(23 \pm 2)$  °C for not less than 12 h for test specimen thicknesses less than or equal to 12 mm, or for not less than 24 h for test specimen thicknesses greater than 12 mm. Unless otherwise specified, the temperature of the test specimen at the beginning of the test shall be  $(23 \pm 2)$  °C.

The test speeds and tolerances shall be in accordance with EN ISO 527-1.

Examples of test speeds for some relevant thermoplastic materials are listed in Annex B.

An extensometer can be attached to either side of the specimen waisted section, between the loading holes, to measure true elongation of the specimen during the test. If used, the extensometer shall comply with EN ISO 527-1.

The complete load/extension curve and failure mode (brittle, ductile or mixed) shall be recorded for each specimen.

At least five test specimens shall be tested for each welded and unwelded test piece.

Welded and unwelded test specimens shall be of the same geometry and shall be tested at the same speed.

## 10 Test equipment

The test equipment shall conform to the requirements given in ISO 5893.

The crosshead displacement shall be continuous, uniform and in accordance with Clause 9 of this document.

## 11 Determination of the tensile energy welding factor

In order to determine the tensile energy welding factor, welded and unwelded test specimens shall be tested.

The tensile energy welding factor is determined from the arithmetic mean values of the energy to break of the welded test specimens ( $E_w$ ) and the unwelded test specimens ( $E_r$ ).

Tensile energy welding factor,  $f_e = \frac{\bar{E}_w}{\bar{E}_r}$

The values of  $E_w$  and  $E_r$  are determined from the areas under the load/extension curves of the welded and unwelded test specimens, respectively, and can be determined using an electronic integrator, planimeter, counting squares or weighing the cut-out curve.

At least ten test specimens (five welded and five unwelded) shall be used in the evaluation of the tensile energy welding factor. No test specimen shall be disregarded unless failure occurs at the loading holes.

## 12 Test report

The test report shall refer to this document and it shall include at least the following information:

- a) reference to this standard;
- b) description and identification of the test piece and test specimens;
- c) appearance of the test pieces before the test:
  - 1) visual examination of weld;
  - 2) beads removed or not;
- d) weld type;
- e) nominal outside diameter of the tube, if applicable;
- f) number of test specimens;
- g) appearance of all surfaces of the test specimens, (e.g. flaws, scratches, visual imperfections);
- h) thickness of test specimen;
- i) type of extensometer (if applicable);
- j) temperature of the test specimen at the beginning of the test;
- k) room temperature during the test;
- l) crosshead speed;
- m) visual examination of the ruptured surface (failure mode);
- n) calculated individual energy to break values;
- o) calculated average energy to break values ( $\bar{E}_w$  and  $\bar{E}_r$ );
- p) calculated value of the tensile energy welding factor ( $f_e$ );
- q) identification of the laboratory;
- r) date of the test;
- s) name and signature of the person responsible for the test report.

**Annex A**  
(normative)

**Cutting specimens of thickness > 30 mm into two or more layers**

Figure A.1 shows how to cut specimens of thickness > 30 mm into multiple layers. When cutting the specimens, a fine-toothed saw shall be used to minimize the material removed.

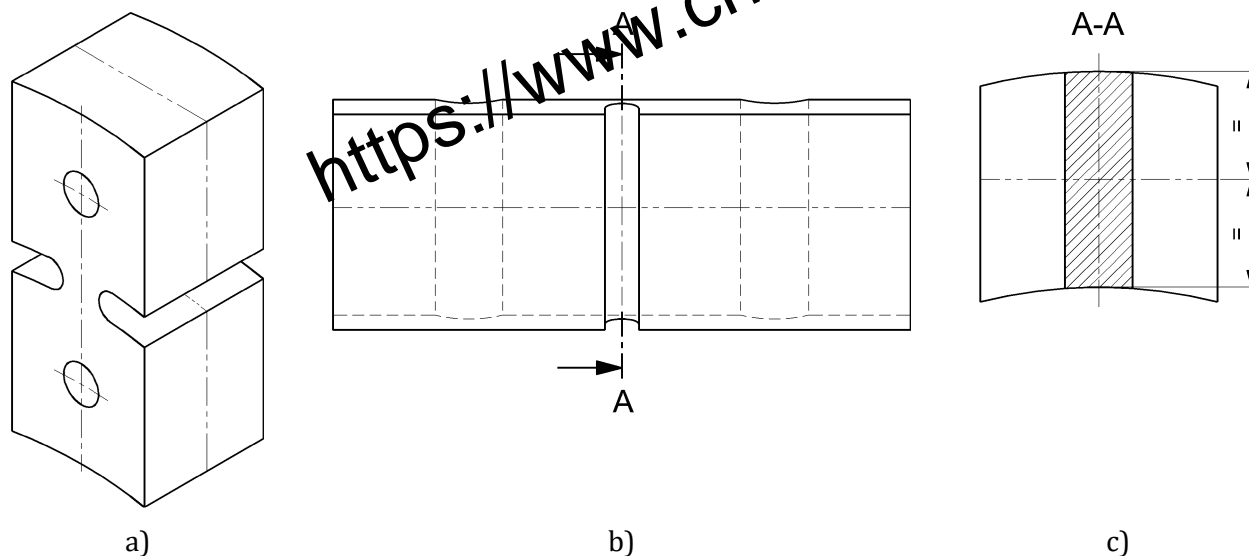

**Key**

- a) isometric view of specimen before cutting, showing the position of the cut
- b) side view
- c) section A-A

**Figure A.1 — Cutting of specimens with a thickness > 30 mm into multiple layers**

## Annex B (informative)

### Test speeds for some thermoplastic materials

The test speeds used for some thermoplastic materials are given in Table B.1.

Table B.1 — Test speeds for some thermoplastic materials

Material	Speed mm/min
PE	5
PP	5
PA-U	5
<b>Key</b> PE polyethylene PP polypropylene PA-U unplasticized polyamide (PA-U 11 or PA-U 12)	

<https://www.china-gauges.com/>

# British Standards Institution (BSI)

BSI is the national body responsible for preparing British Standards and other standards-related publications, information and services.

BSI is incorporated by Royal Charter. British Standards and other standardization products are published by BSI Standards Limited.

## About us

We bring together business, industry, government, consumers, innovators and others to shape their combined experience and expertise into standards-based solutions.

The knowledge embodied in our standards has been carefully assembled in a dependable format and refined through our open consultation process. Organizations of all sizes and across all sectors choose standards to help them achieve their goals.

## Information on standards

We can provide you with the knowledge that your organization needs to succeed. Find out more about British Standards by visiting our website at [bsigroup.com/standards](http://bsigroup.com/standards) or contacting our Customer Services team or Knowledge Centre.

## Buying standards

You can buy and download PDF versions of BSI publications, including British and adopted European and international standards, through our website at [bsigroup.com/shop](http://bsigroup.com/shop), where hard copies can also be purchased.

If you need international and foreign standards from other Standards Development Organizations, hard copies can be ordered from our Customer Services team.

## Copyright in BSI publications

All the content in BSI publications, including British Standards, is the property of and copyrighted by BSI or some person or entity that owns copyright in the information used (such as the international standardization bodies) and has formally licensed such information to BSI for commercial publication and use.

Save for the provisions below, you may not transfer, share or disseminate any portion of the standard to any other person. You may not adapt, distribute, commercially exploit or publicly display the standard or any portion thereof in any manner whatsoever without BSI's prior written consent.

## Storing and using standards

Standards purchased in soft copy format:

- A British Standard purchased in soft copy format is licensed to a sole named user for personal or internal company use only.
- The standard may be stored on more than one device provided that it is accessible by the sole named user only and that only one copy is accessed at any one time.
- A single paper copy may be printed for personal or internal company use only.

Standards purchased in hard copy format:

- A British Standard purchased in hard copy format is for personal or internal company use only.
- It may not be further reproduced – in any format – to create an additional copy. This includes scanning of the document.

If you need more than one copy of the document, or if you wish to share the document on an internal network, you can save money by choosing a subscription product (see 'Subscriptions').

## Reproducing extracts

For permission to reproduce content from BSI publications contact the BSI Copyright and Licensing team.

## Subscriptions

Our range of subscription services are designed to make using standards easier for you. For further information on our subscription products go to [bsigroup.com/subscriptions](http://bsigroup.com/subscriptions).

With **British Standards Online (BSOL)** you'll have instant access to over 55,000 British and adopted European and international standards from your desktop. It's available 24/7 and is refreshed daily so you'll always be up to date.

You can keep in touch with standards developments and receive substantial discounts on the purchase price of standards, both in single copy and subscription format, by becoming a **BSI Subscribing Member**.

**PLUS** is an updating service exclusive to BSI Subscribing Members. You will automatically receive the latest hard copy of your standards when they're revised or replaced.

To find out more about becoming a BSI Subscribing Member and the benefits of membership, please visit [bsigroup.com/shop](http://bsigroup.com/shop).

With a **Multi-User Network Licence (MUNL)** you are able to host standards publications on your intranet. Licences can cover as few or as many users as you wish. With updates supplied as soon as they're available, you can be sure your documentation is current. For further information, email [cservices@bsigroup.com](mailto:cservices@bsigroup.com).

## Revisions

Our British Standards and other publications are updated by amendment or revision.

We continually improve the quality of our products and services to benefit your business. If you find an inaccuracy or ambiguity within a British Standard or other BSI publication please inform the Knowledge Centre.

## Useful Contacts

### Customer Services

**Tel:** +44 345 086 9001

**Email:** [cservices@bsigroup.com](mailto:cservices@bsigroup.com)

### Subscriptions

**Tel:** +44 345 086 9001

**Email:** [subscriptions@bsigroup.com](mailto:subscriptions@bsigroup.com)

### Knowledge Centre

**Tel:** +44 20 8996 7004

**Email:** [knowledgecentre@bsigroup.com](mailto:knowledgecentre@bsigroup.com)

### Copyright & Licensing

**Tel:** +44 20 8996 7070

**Email:** [copyright@bsigroup.com](mailto:copyright@bsigroup.com)

## BSI Group Headquarters

389 Chiswick High Road London W4 4AL UK